

Randolph/Hampton Fire District

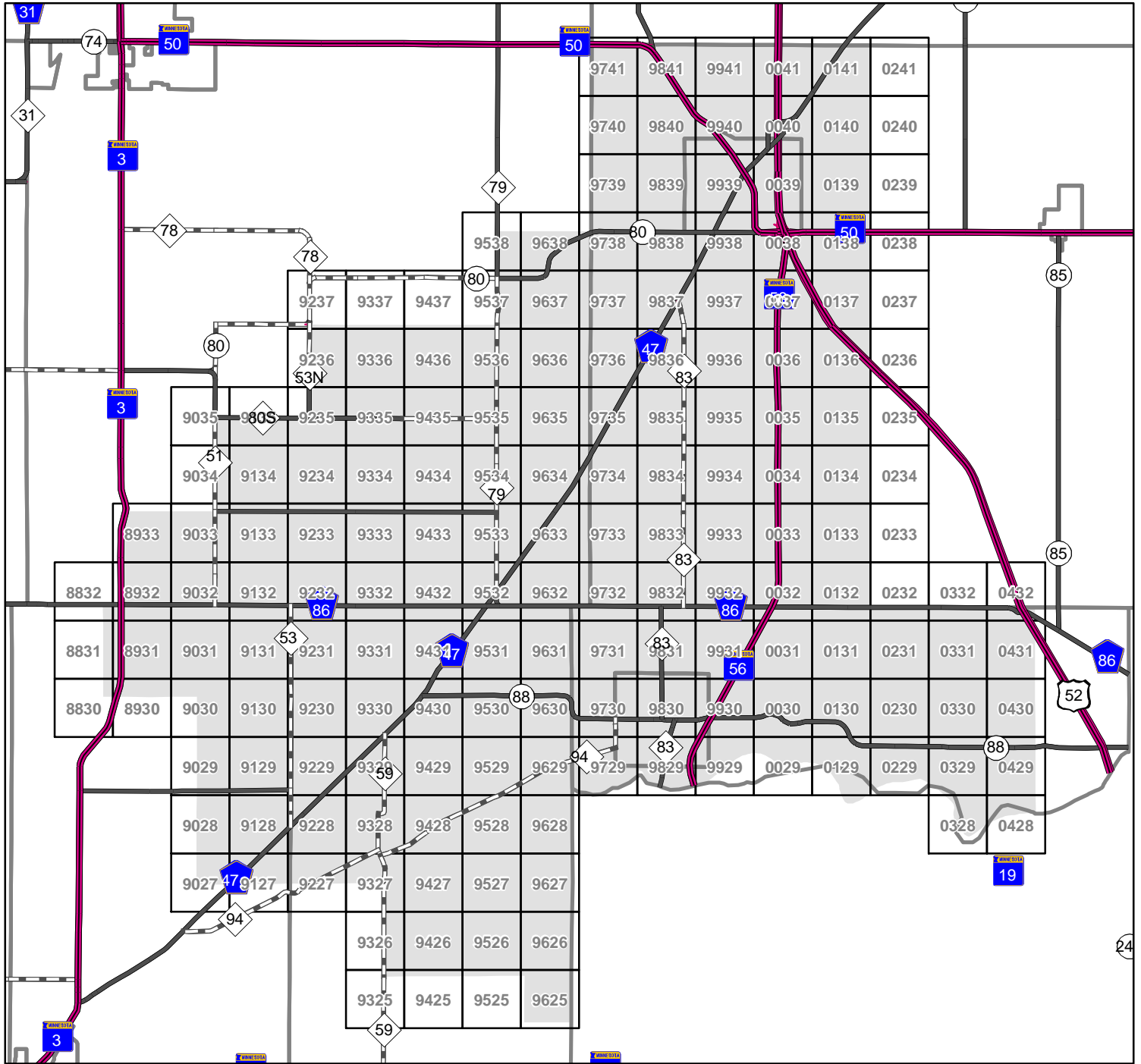

Legend

- | | | | | | | | |
|--|----------------------------------|--|------------------------------|--|-------------------------|--|------------------------------|
| | Fire Hydrant | | Road Edge/Curb Edge/Sidewalk | | Buildings | | State/Local Park |
| | Church | | Driveway | | Military Install | | Zoo |
| | School | | Gravel Road | | Marinas | | Arboretums/Nature Centers |
| | City Hall | | Trail | | Educational Institution | | Fair Grounds |
| | Fire Station | | Railroad Track | | Airport or Airfield | | Beach |
| | Hospital/Clinic/Medical Facility | | Creek/Stream | | Industrial Park | | Island |
| | Library | | Ditch | | Amusement Center | | Lake or Pond |
| | Police Station | | State Trail | | Golf Course | | parcels_dako |
| | County Service Center | | | | Cemetery | | City and Township Boundaries |
| | Shopping Center | | | | National Park | | County Boundary |
| | | | | | | | 100 Meter USNG |

Reading US National Grid (USNG) Coordinates: “Read right, then up.”

Information Sheet 1 in this series.

FGDC-STD-011-2001

From www.fgdc.gov/usng

The example below locates the Jefferson Pier at USNG: 18S UJ 23371 06519.

| U.S. National Grid | |
|-----------------------|------------------|
| 100,000-m Square ID | |
| UJ | ⁴³ 00 |
| UH | |
| Grid Zone Designation | |
| 18S | |

A USNG value has three components.

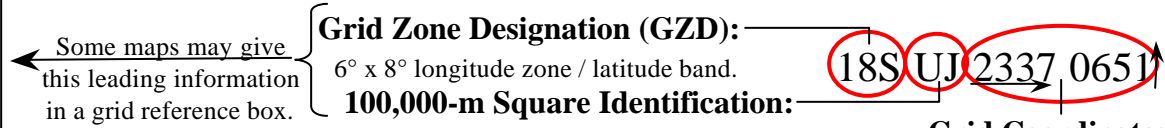

“Read right, then up.”

- Grid lines are identified by **Principal Digits**. Ignore the small superscript numbers like those in the lower left corner of this map.

Reading USNG Grid Coordinates.

- Coordinates are always given as an even number of digits (i.e. 23370651).

- Separate coordinates in half (2337 0651) into the easting and northing components.

¹- Read right to grid line 23. ² Then measure right another 370 meters. (Think 23.37)

³- Read up to grid line 06. ⁴ Then measure up another 510 meters. (Think 06.51)

| Grid: | Examples: |
|-----------|--------------------------|
| 228058 | FDR Memorial: + |
| 231054 | George Mason Memorial: + |
| 2338 0710 | Zero Milestone: + |
| 2275 0628 | DC War Memorial: + |
| 213017 | Ft. Scott Park: |

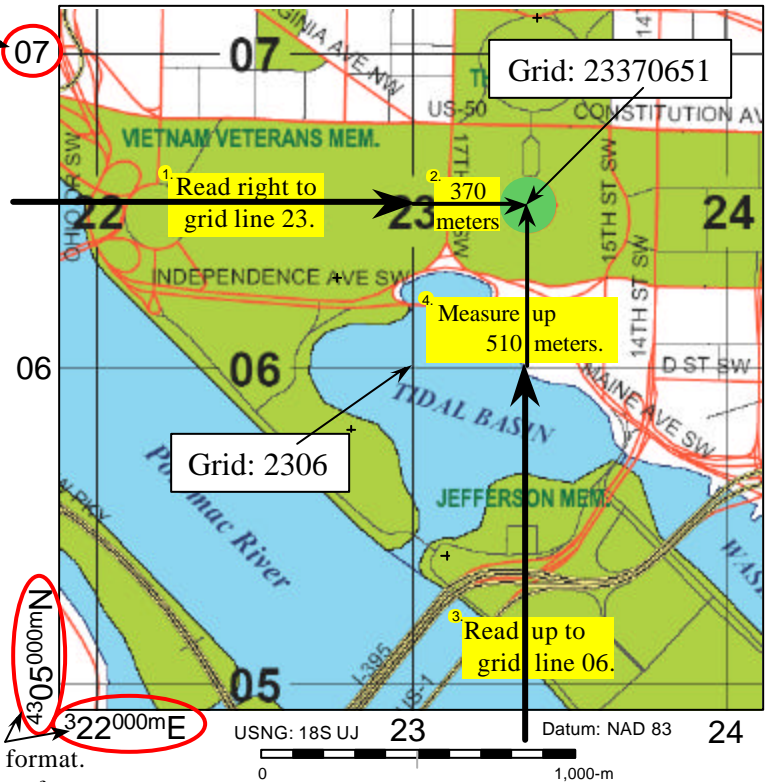

Ignore the small UTM superscript numbers that are provided for reference purposes.

UTM numerical values are best suited for determining direction and distance as in surveying. USNG alpha-numeric values are best suited for describing particular locations because they can be given as only grid coordinates and with only the precision required for a particular task.

| Users determine the required precision. These values represent a point position (southwest corner) for an area of refinement. | Four digits: | 23 06 | Locating a point within a 1,000-m square. |
|---|---------------|-------------|---|
| | Six digits: | 233 065 | Locating a point within a 100-m square (football field size). |
| | Eight digits: | 2337 0651 | Locating a point within a 10-m square (modest size home). |
| | Ten digits: | 23371 06519 | Locating a point within a 1-m square (parking space size). |

A modest size home can be found or identified in a local area with only an 8-digit grid. → Full USNG: 18S UJ 2337 0651 - World wide unique.
 Without Grid Zone Designation (GZD): UJ 2337 0651 - Regional areas.
 Without GZD and 100,000-m Square ID: 2337 0651 - Local areas.

This illustrates how USNG coordinates can be used in a phone directory or advertisement like a universal map index value. Unlike classic atlas grids (i.e. B3), these can be used with any paper map using the national grid and in web map portals such as the Washington, DC GIS (<http://dcgis.dc.gov>) or The National Map (<http://nmviewogc.cr.usgs.gov/viewer.htm>)

They can also be used in consumer GPS receivers to directly guide you to the location. This is especially beneficial at night, in heavy traffic, or after major disasters when street signs are missing.

| Point of Interest | Street Address | USNG Grid: 18S UJ | Telephone: (202) |
|--------------------------|---------------------|-------------------|------------------|
| Subway Sandwich & Salads | 2030 M St., NW | 2256 0826 | 223-2587 |
| Subway Sandwich & Salads | 430 8th St., SE | 2698 0567 | 547-8200 |
| Subway Sandwich & Salads | 3504 12th St., NE | 2740 1120 | 526-5999 |
| Subway Sandwich & Salads | 1500 Benning Rd, NE | 2815 0757 | 388-0421 |

US National Grid (USNG) Coordinates: *World wide context.*

Information Sheet 2 in this series.

FGDC-STD-011-2001

From www.fgdc.gov/usng

The example below locates the Jefferson Pier at USNG: 18S UJ 23371 06519.

| U.S. National Grid | |
|-----------------------|-------|
| 100,000-m Square ID | |
| UJ | 43 00 |
| UH | |
| Grid Zone Designation | 18S |

A USNG value has three components.

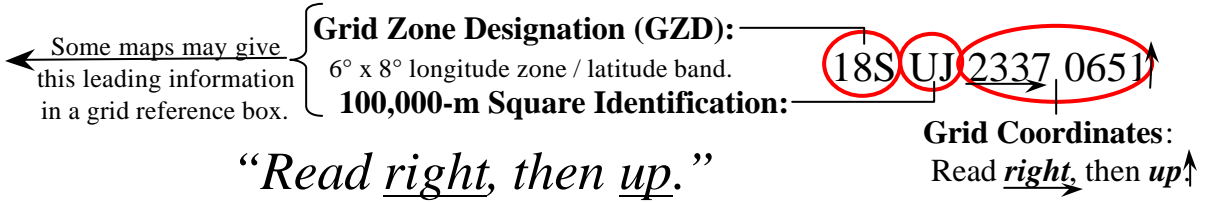

USNG values have three components as seen above. The GZD gives a USNG value world-wide context with 60 longitudinal zones each 6° wide. Zones 10 - 19 cover the conterminous US as seen below left. Zones are divided into 8° latitudinal bands. Together these make up Grid Zone Designations (GZD). Example: 18S

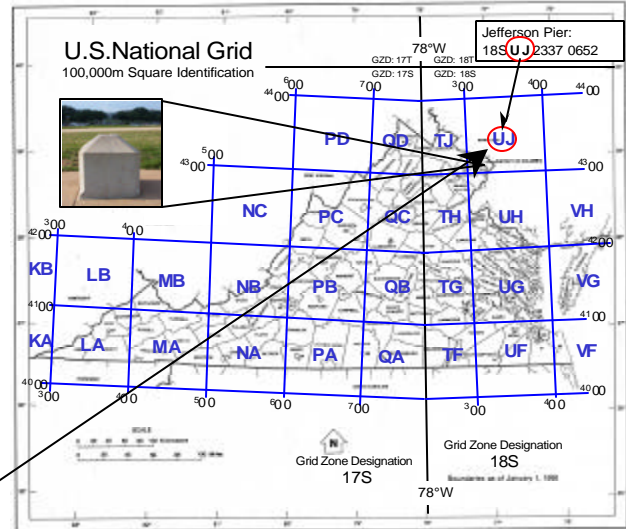
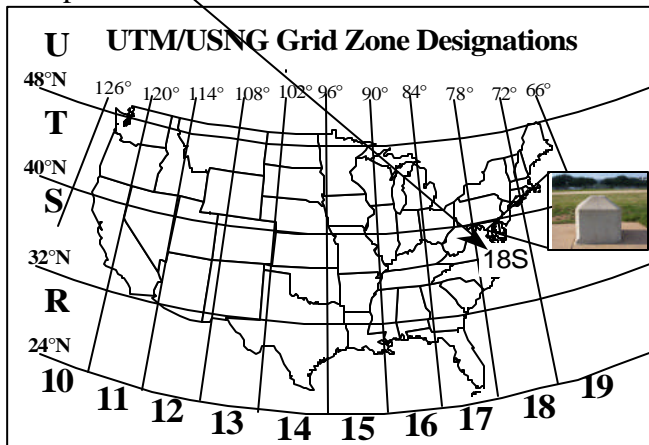

100,000-m Square Identifications
Example: UJ

GZDs are further subdivided into large squares with 100,000-m Square Identifications. In this example, the Jefferson Pier is located in UJ. These squares are organized and lettered so they do not repeat themselves but every 18°, which is approximately 1,000 miles in the mid-latitudes. The illustration at right depicts how far one must go before the letters UJ repeat. This ensures a given value such as UJ 2337 0651 is unique out of the entire state it is located in, as well as all surrounding states.

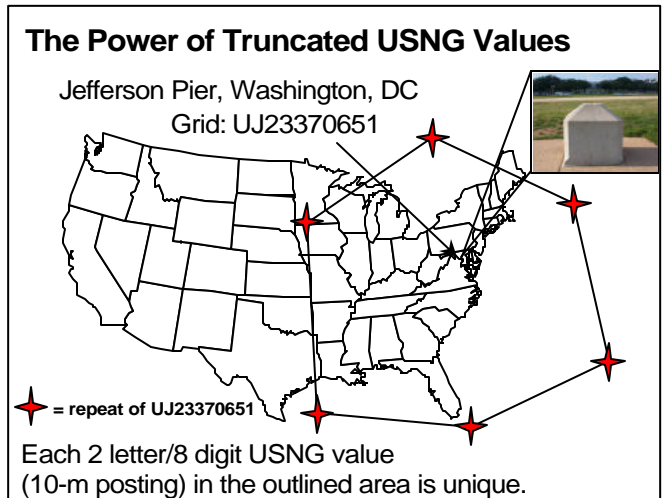

In general, people can use the grid coordinates alone--for example: 233 065. Although the same numbers recurs about every 60 miles, normally that will cause no problem when the general location is understood. This is similar to the way you would tell someone only the last digits of a phone number when the area code is obvious. If there is a possibility of confusion include the letter pair too--for example: UJ 233 065. A letter pair recurs about every 1000 miles, so even in a disaster relief project there will be no other point with those coordinates in a local area. Full USNG coordinates such as 18S UJ 233 065 are worldwide unique. Typically a GPS or other electronic device requires coordinates in that form since unlike a human it doesn't intuitively understand the general location from context. You should always give full coordinates whenever abbreviated coordinates might not be clear or when listing them on letterhead, a business card or advertisement.

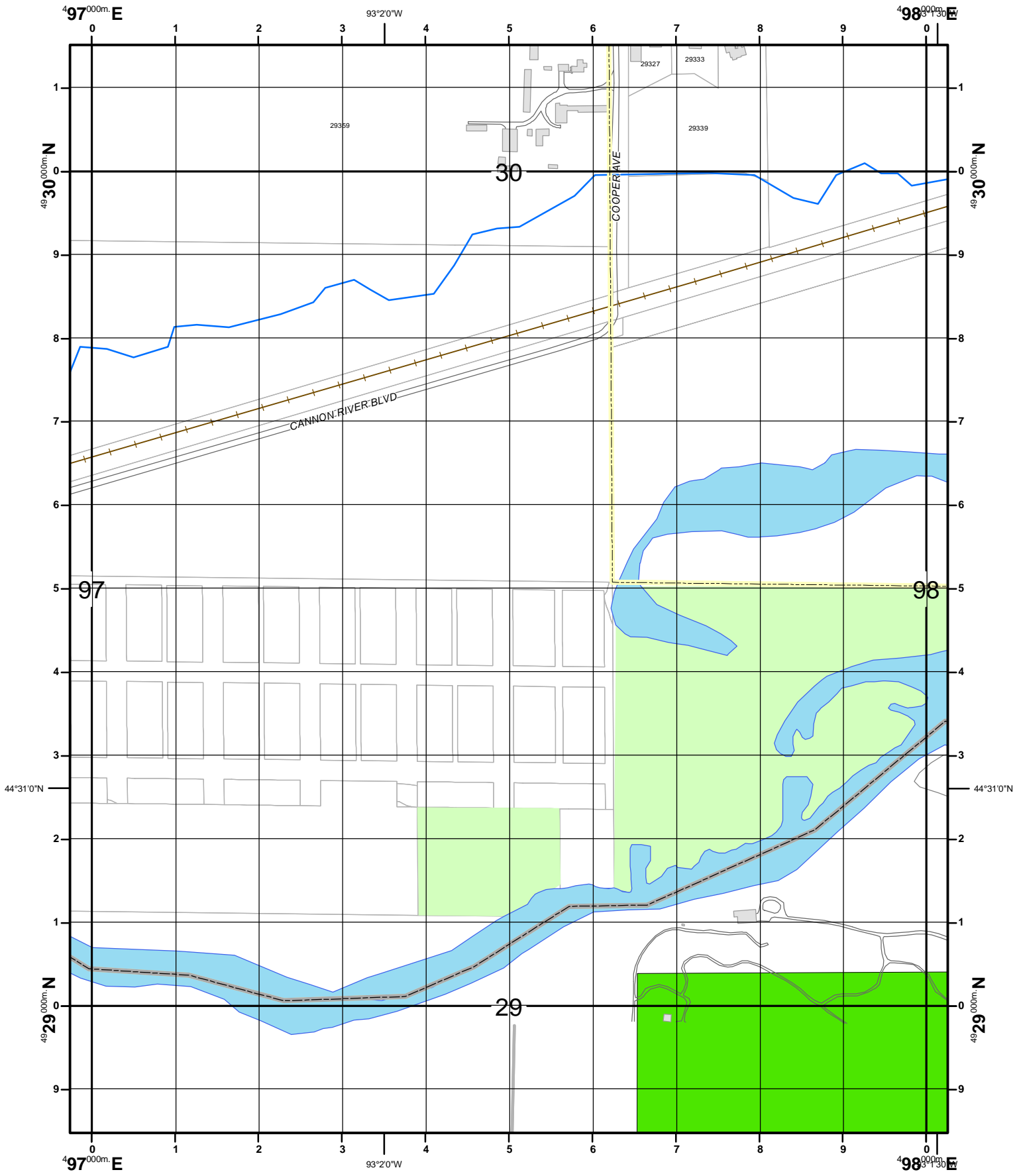

1000-m GRID, US NATIONAL GRID
 NORTH AMERICAN DATUM 1983
 GRID ZONE DESIGNATION 15T
 100,000-m SQUARE IDENTIFICATION: VK

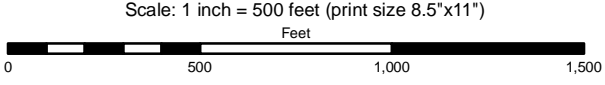

| | | |
|------|-------------|------|
| 9630 | 9730 | 9830 |
| 9629 | 9729 | 9829 |
| 9628 | 9728 | 9828 |



PREPARED BY: DAKOTA COUNTY OFFICE OF GIS, NOVEMBER 25, 2009
 CORRECTIONS AND ADDITIONS SHOULD BE BROUGHT TO THE ATTENTION OF THE ABOVE ORGANIZATION
 PHONE : (952) 891-7081
 This map was created using the FGDC Standard for the U.S. National Grid
 FGDC-STD-011-2001

For additional information
 see <http://www.fgdc.gov/usng>

| |
|----------------------|
| U.S. National Grid |
| 100,000-m Square ID |
| VK |
| Grid Zone Designator |
| 15T |

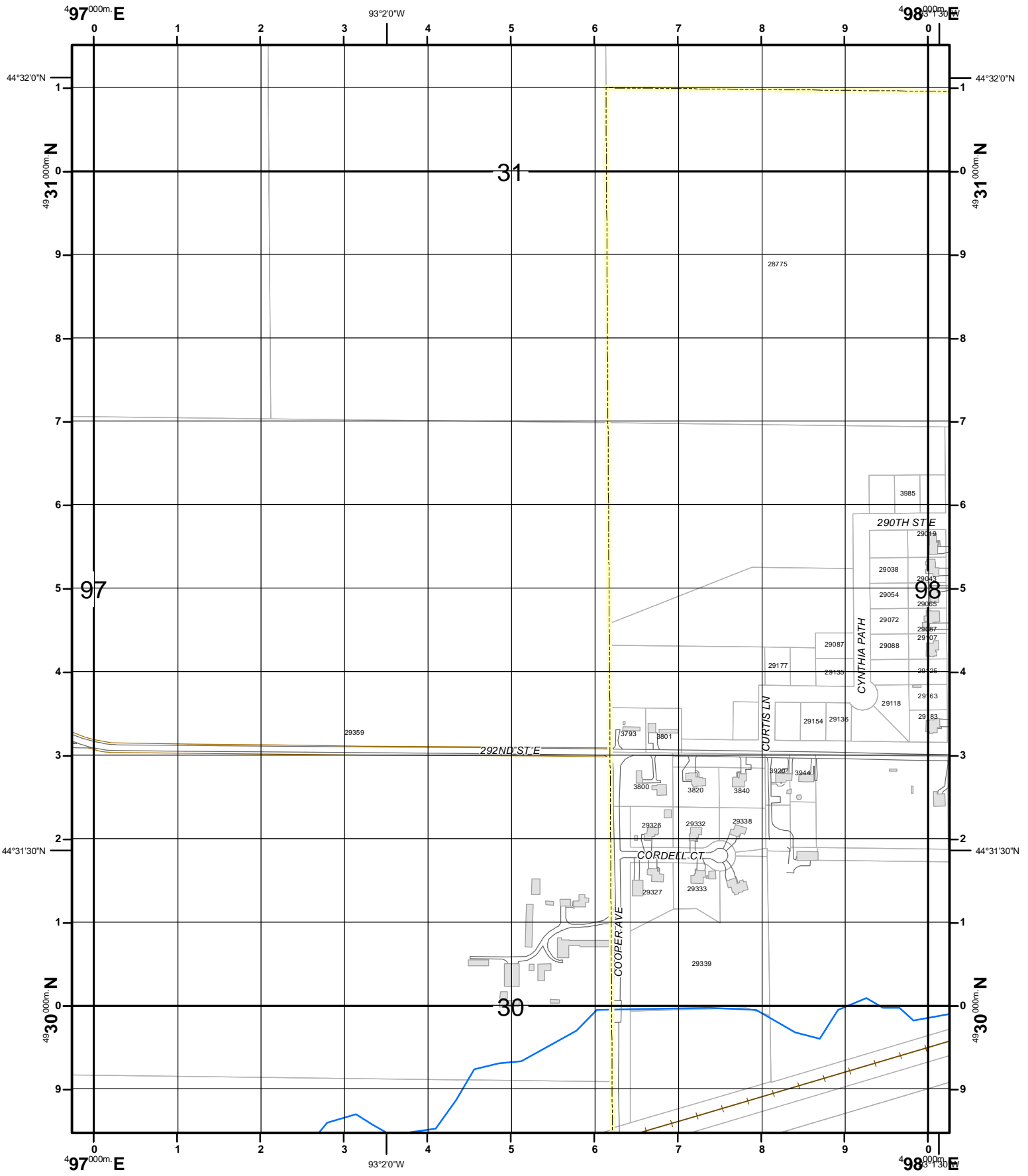

1000-m GRID, US NATIONAL GRID
 NORTH AMERICAN DATUM 1983
 GRID ZONE DESIGNATION 15T
 100,000-m SQUARE IDENTIFICATION: VK

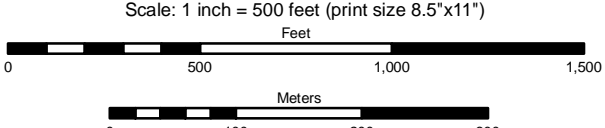

| |
|----------------------|
| U.S. National Grid |
| 100,000-m Square ID |
| VK |
| Grid Zone Designator |
| 15T |

PREPARED BY: DAKOTA COUNTY OFFICE OF GIS, NOVEMBER 25, 2009
 CORRECTIONS AND ADDITIONS SHOULD BE BROUGHT TO THE ATTENTION OF THE ABOVE ORGANIZATION
 PHONE : (952) 891-7081
 This map was created using the FGDC Standard for the U.S. National Grid
 FGDC-STD-011-2001

| | | |
|------|------|------|
| 9631 | 9731 | 9831 |
| 9630 | 9730 | 9830 |
| 9629 | 9729 | 9829 |



9730

For additional information
 see <http://www.fgdc.gov/usng>

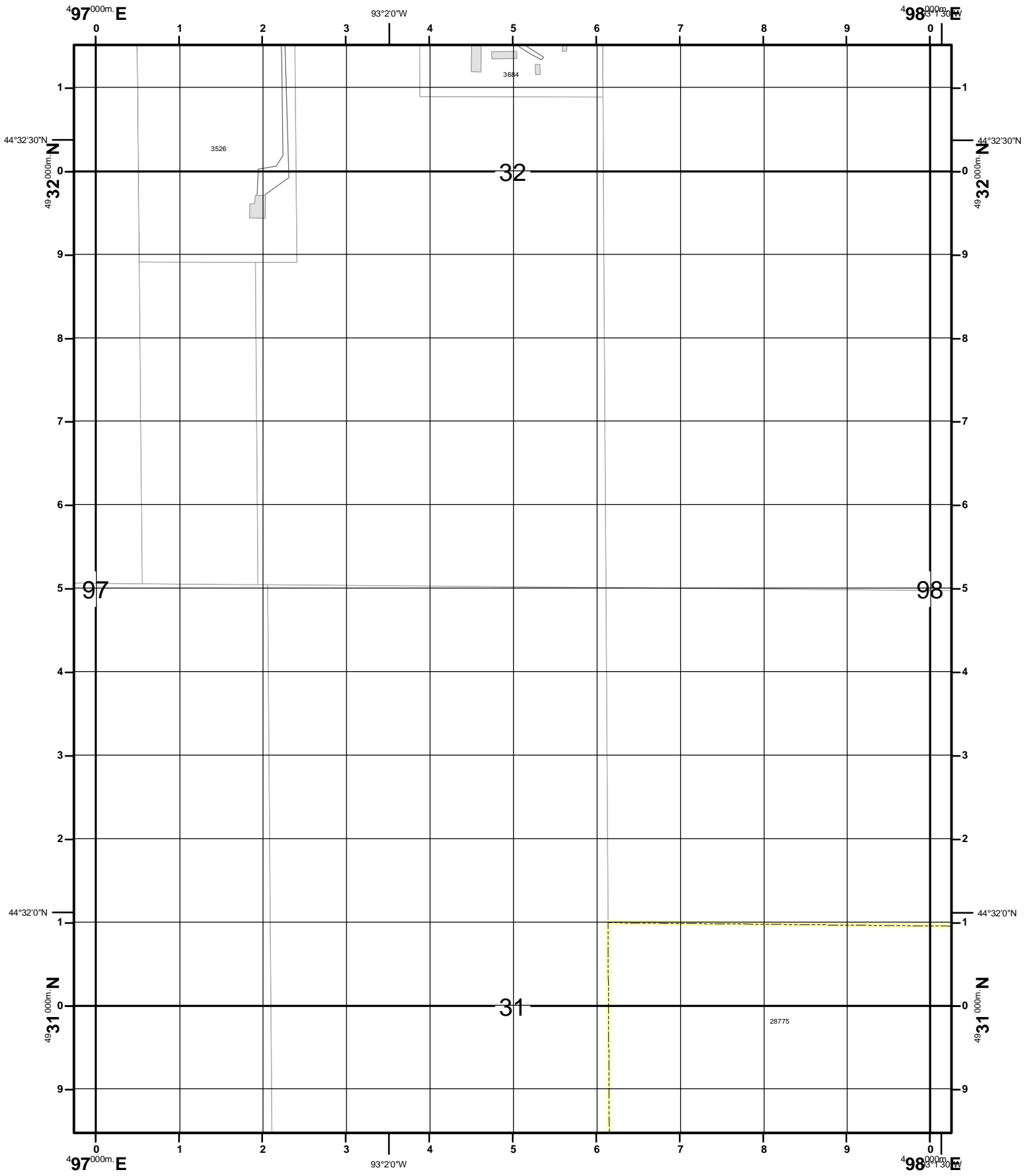

1000-m GRID, US NATIONAL GRID
 NORTH AMERICAN DATUM 1983
 GRID ZONE DESIGNATION 15T
 100,000-m SQUARE IDENTIFICATION: VK

| |
|----------------------|
| U.S. National Grid |
| 100,000-m Square ID |
| VK |
| Grid Zone Designator |
| 15T |

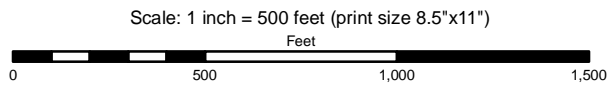

PREPARED BY: DAKOTA COUNTY OFFICE OF GIS, NOVEMBER 25, 2009
 CORRECTIONS AND ADDITIONS SHOULD BE BROUGHT TO THE ATTENTION OF THE ABOVE ORGANIZATION
 PHONE : (952) 891-7081
 This map was created using the FGDC Standard for the U.S. National Grid
 FGDC-STD-011-2001

| | | |
|------|------|------|
| 9632 | 9732 | 9832 |
| 9631 | 9731 | 9831 |
| 9630 | 9730 | 9830 |

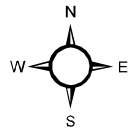

9731

For additional information
 see <http://www.fgdc.gov/usng>

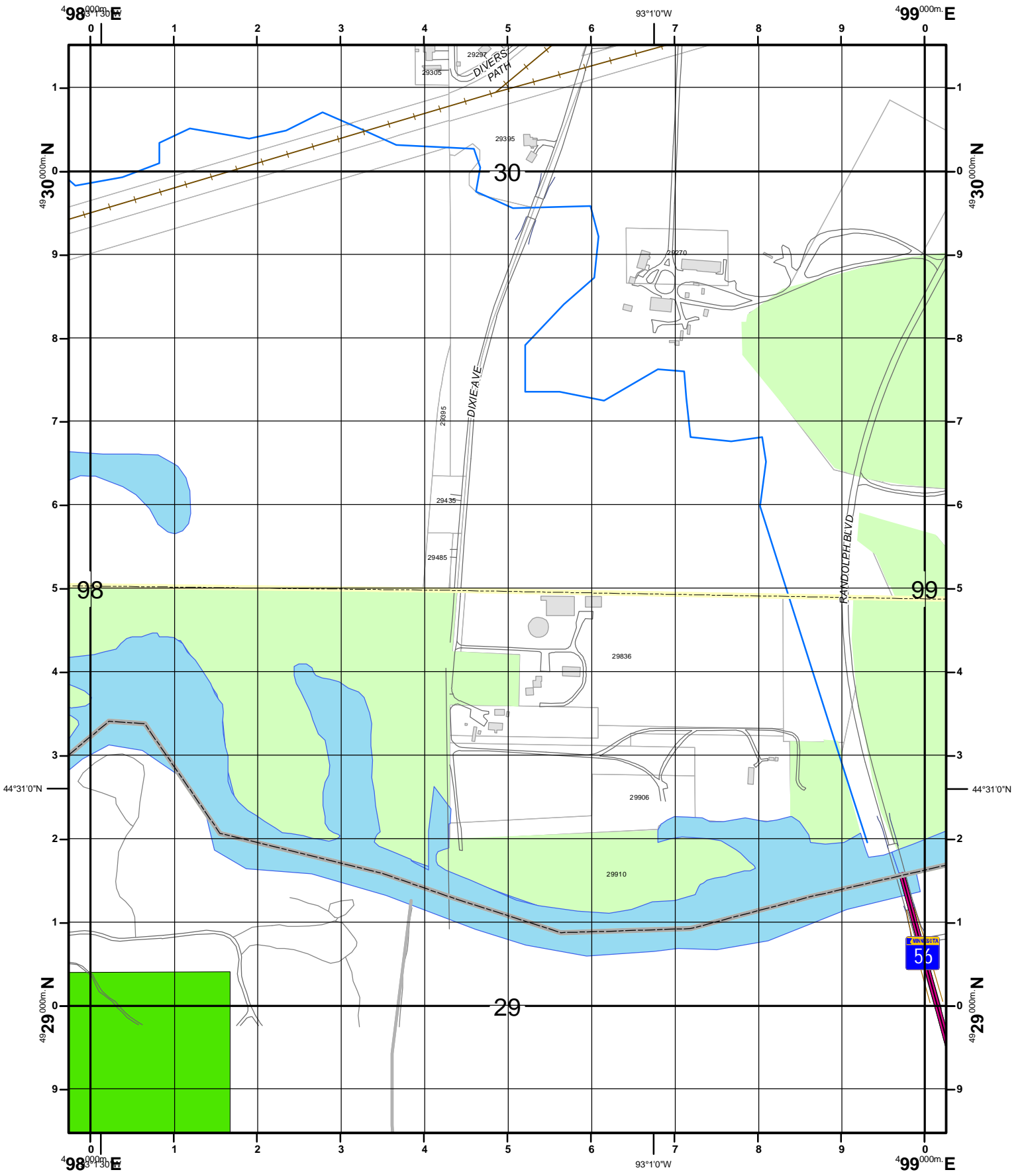

1000-m GRID, US NATIONAL GRID
 NORTH AMERICAN DATUM 1983
 GRID ZONE DESIGNATION 15T
 100,000-m SQUARE IDENTIFICATION: VK

| |
|----------------------|
| U.S. National Grid |
| 100,000-m Square ID |
| VK |
| Grid Zone Designator |
| 15T |

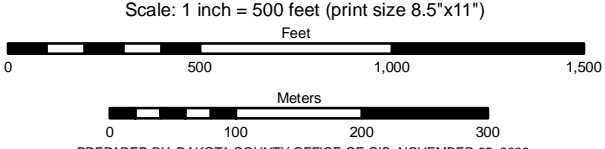

PREPARED BY: DAKOTA COUNTY OFFICE OF GIS, NOVEMBER 25, 2009
 CORRECTIONS AND ADDITIONS SHOULD BE BROUGHT TO THE ATTENTION OF THE ABOVE ORGANIZATION
 PHONE : (952) 891-7081
 This map was created using the FGDC Standard for the U.S. National Grid
 FGDC-STD-011-2001

| | | |
|------|-------------|------|
| 9730 | 9830 | 9930 |
| 9729 | 9829 | 9929 |
| 9728 | 9828 | 9928 |



For additional information
 see <http://www.fgdc.gov/usng>

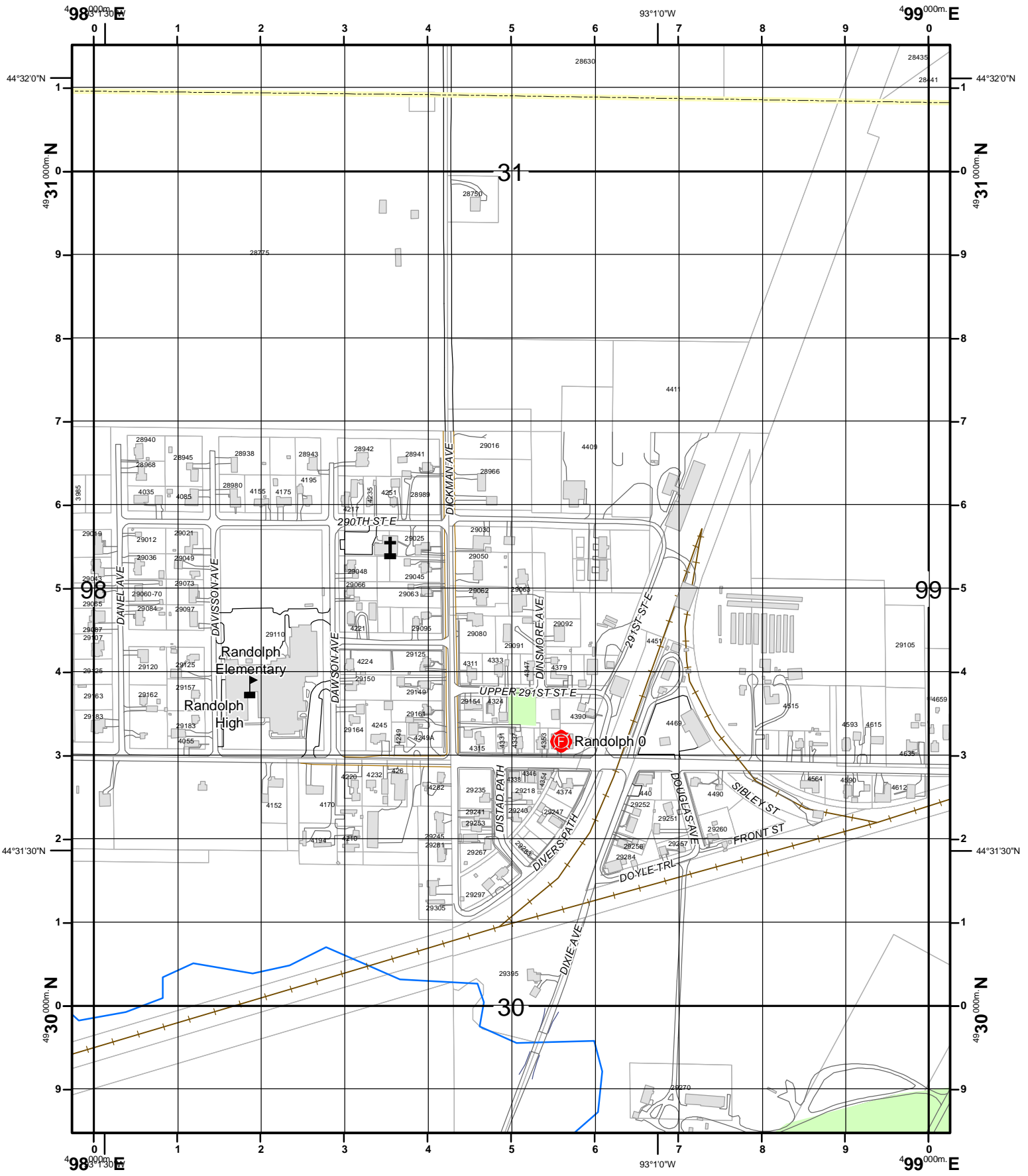

Scale: 1 inch = 500 feet (print size 8.5"x11")

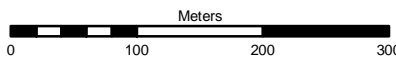
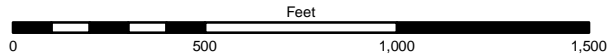

1000-m GRID, US NATIONAL GRID
 NORTH AMERICAN DATUM 1983
 GRID ZONE DESIGNATION 15T
 100,000-m SQUARE IDENTIFICATION: VK

| |
|----------------------|
| U.S. National Grid |
| 100,000-m Square ID |
| VK |
| Grid Zone Designator |
| 15T |

PREPARED BY: DAKOTA COUNTY OFFICE OF GIS, NOVEMBER 25, 2009
 CORRECTIONS AND ADDITIONS SHOULD BE BROUGHT TO THE ATTENTION OF THE ABOVE ORGANIZATION
 PHONE : (952) 891-7081
 This map was created using the FGDC Standard for the U.S. National Grid
 FGDC-STD-011-2001

For additional information
 see <http://www.fgdc.gov/usng>

| | | |
|------|-------------|------|
| 9731 | 9831 | 9931 |
| 9730 | 9830 | 9930 |
| 9729 | 9829 | 9929 |

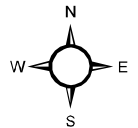

9830

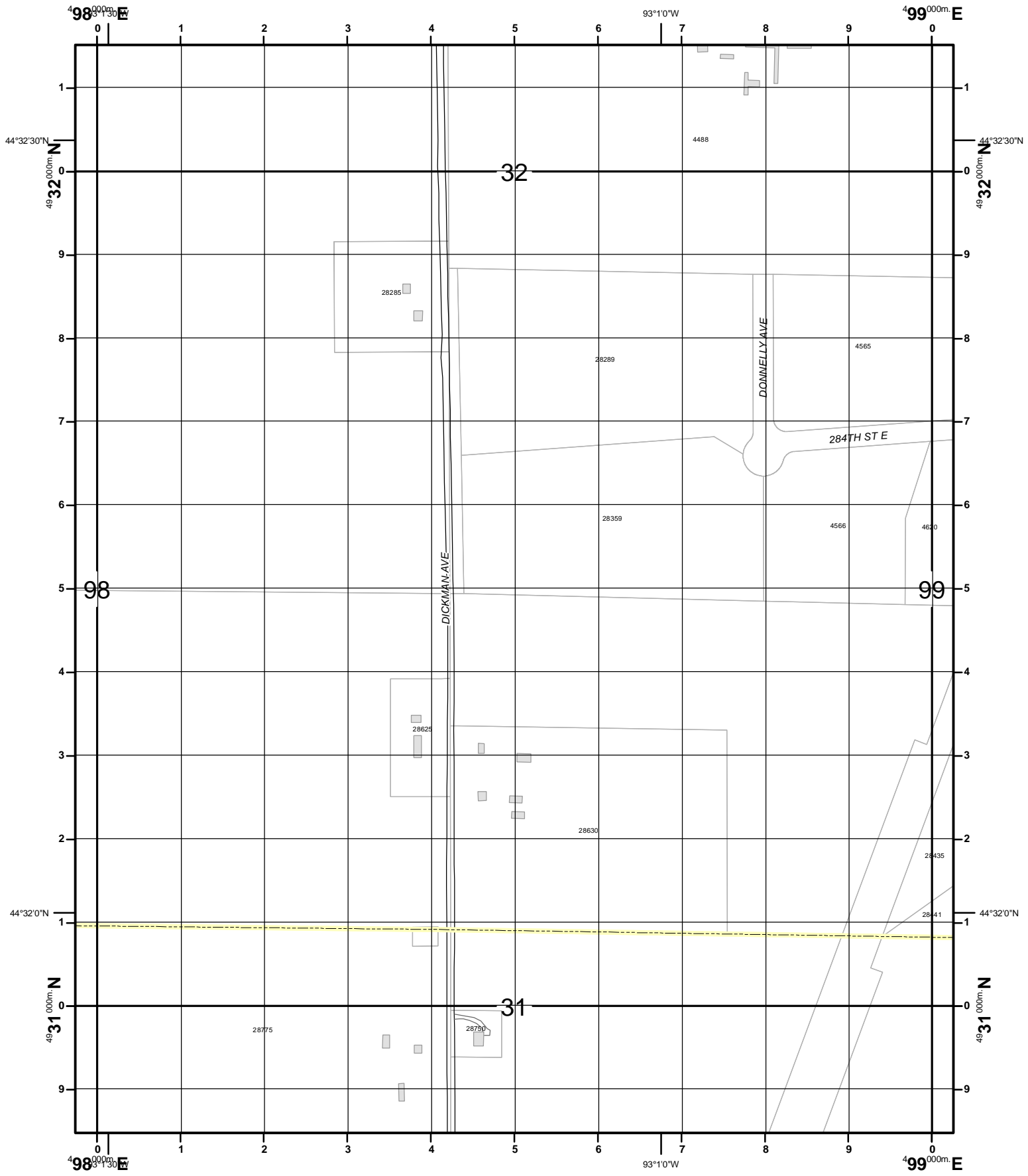

1000-m GRID, US NATIONAL GRID
 NORTH AMERICAN DATUM 1983
 GRID ZONE DESIGNATION 15T
 100,000-m SQUARE IDENTIFICATION: VK

| |
|----------------------|
| U.S. National Grid |
| 100,000-m Square ID |
| VK |
| Grid Zone Designator |
| 15T |

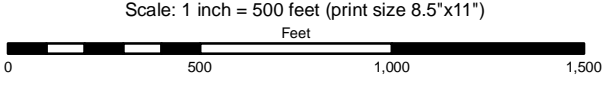

PREPARED BY: DAKOTA COUNTY OFFICE OF GIS, NOVEMBER 25, 2009
 CORRECTIONS AND ADDITIONS SHOULD BE BROUGHT TO THE ATTENTION OF THE ABOVE ORGANIZATION
 PHONE : (952) 891-7081
 This map was created using the FGDC Standard for the U.S. National Grid
 FGDC-STD-011-2001

| | | |
|------|------|------|
| 9732 | 9832 | 9932 |
| 9731 | 9831 | 9931 |
| 9730 | 9830 | 9930 |



9831

For additional information
 see <http://www.fgdc.gov/usng>

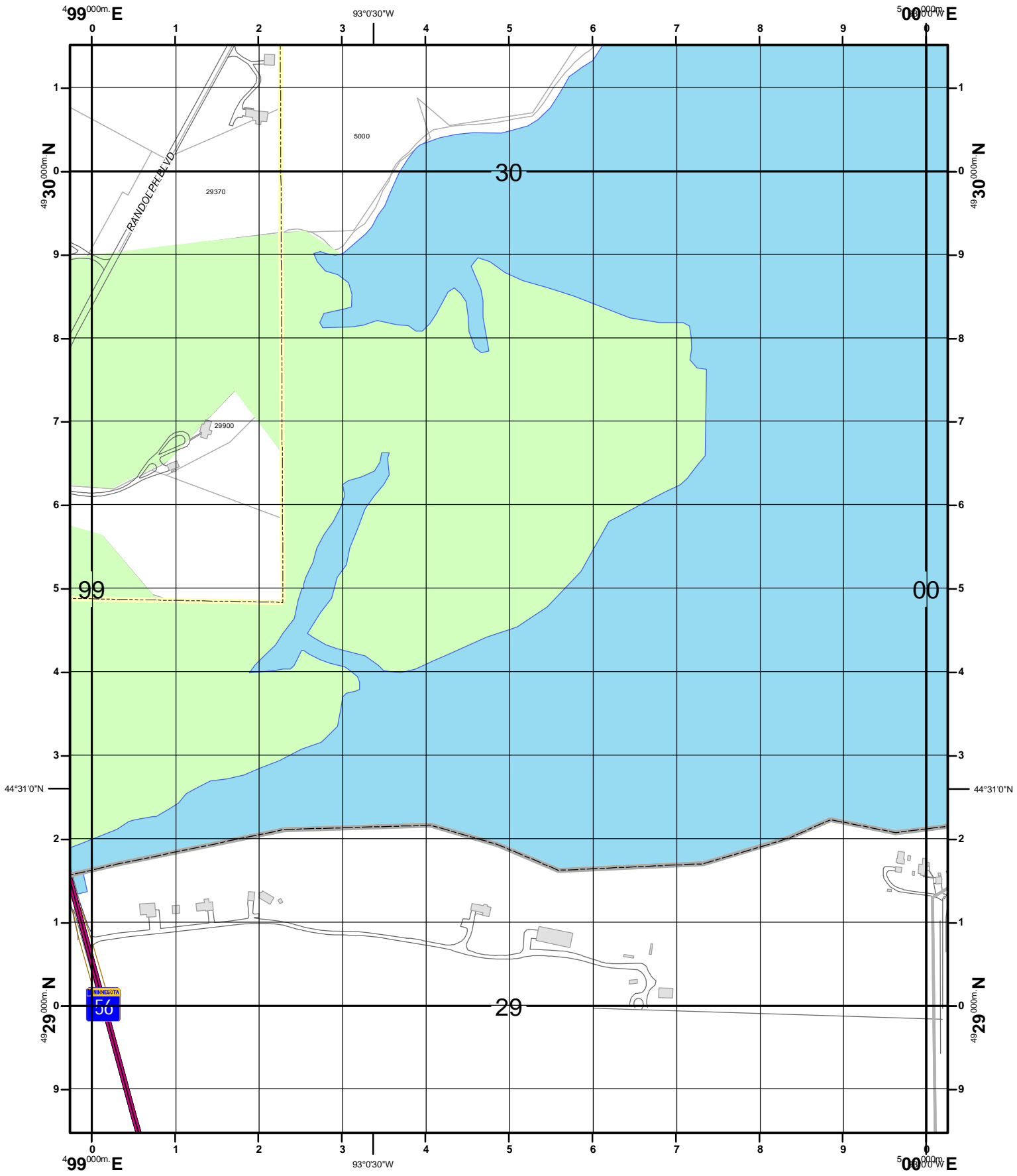

1000-m GRID, US NATIONAL GRID
 NORTH AMERICAN DATUM 1983
 GRID ZONE DESIGNATION 15T
 100,000-m SQUARE IDENTIFICATION: VK

| |
|----------------------|
| U.S. National Grid |
| 100,000-m Square ID |
| VK |
| Grid Zone Designator |
| 15T |

Scale: 1 inch = 500 feet (print size 8.5"x11")

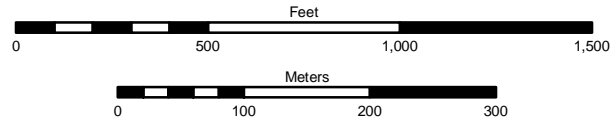

PREPARED BY: DAKOTA COUNTY OFFICE OF GIS, NOVEMBER 25, 2009
 CORRECTIONS AND ADDITIONS SHOULD BE BROUGHT TO THE ATTENTION OF THE ABOVE ORGANIZATION
 PHONE : (952) 891-7081
 This map was created using the FGDC Standard for the U.S. National Grid
 FGDC-STD-011-2001

For additional information
 see <http://www.fgdc.gov/usng>

| | | |
|------|------|------|
| 9830 | 9930 | 0030 |
| 9829 | 9929 | 0029 |
| 9828 | 9928 | 0028 |

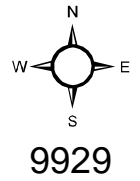

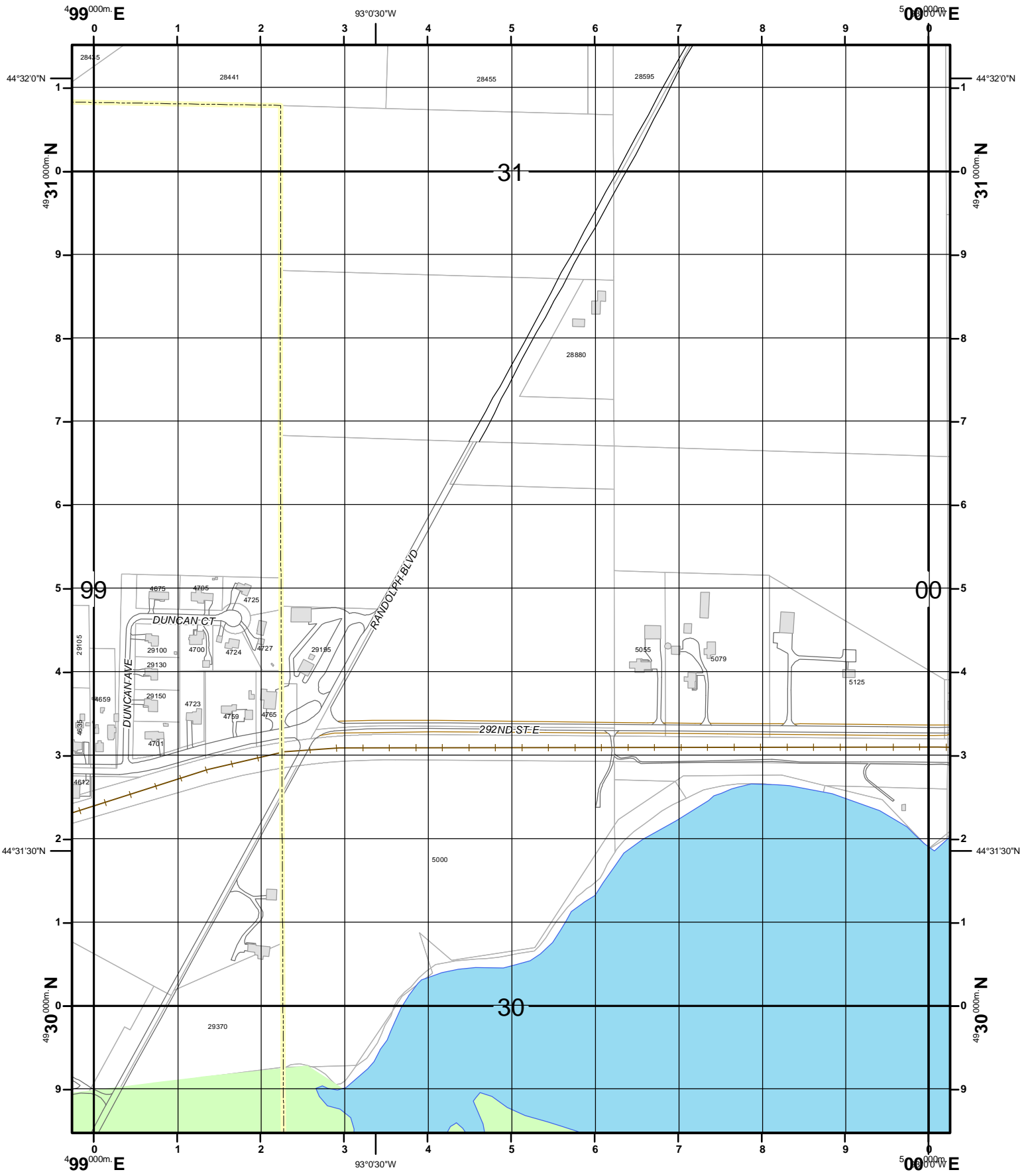

1000-m GRID, US NATIONAL GRID
 NORTH AMERICAN DATUM 1983
 GRID ZONE DESIGNATION 15T
 100,000-m SQUARE IDENTIFICATION: VK

Scale: 1 inch = 500 feet (print size 8.5"x11")

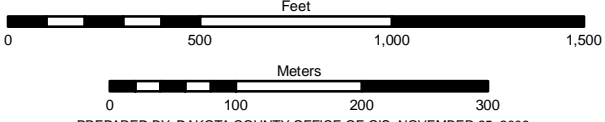

| |
|----------------------|
| U.S. National Grid |
| 100,000-m Square ID |
| VK |
| Grid Zone Designator |
| 15T |

PREPARED BY: DAKOTA COUNTY OFFICE OF GIS, NOVEMBER 25, 2009
 CORRECTIONS AND ADDITIONS SHOULD BE BROUGHT TO THE ATTENTION OF THE ABOVE ORGANIZATION
 PHONE : (952) 891-7081
 This map was created using the FGDC Standard for the U.S. National Grid
 FGDC-STD-011-2001

For additional information
 see <http://www.fgdc.gov/usng>

| | | |
|------|-------------|------|
| 9831 | 9931 | 0031 |
| 9830 | 9930 | 0030 |
| 9829 | 9929 | 0029 |

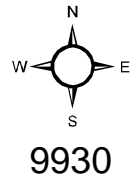

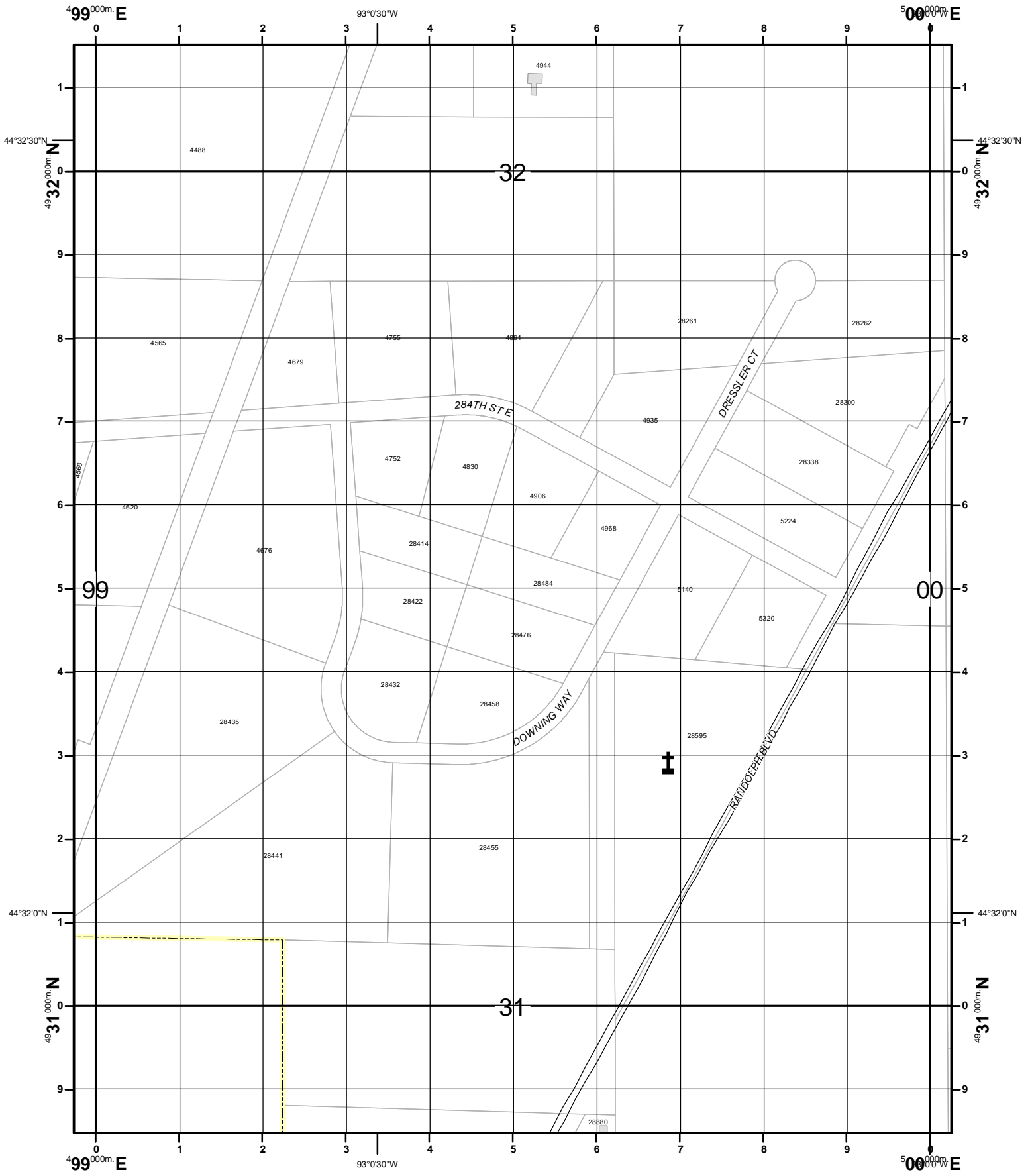

1000-m GRID, US NATIONAL GRID
 NORTH AMERICAN DATUM 1983
 GRID ZONE DESIGNATION 15T
 100,000-m SQUARE IDENTIFICATION: VK

| |
|----------------------|
| U.S. National Grid |
| 100,000-m Square ID |
| VK |
| Grid Zone Designator |
| 15T |

Scale: 1 inch = 500 feet (print size 8.5"x11")

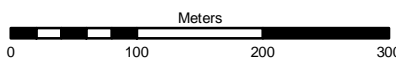
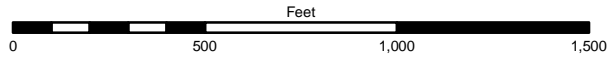

PREPARED BY: DAKOTA COUNTY OFFICE OF GIS, NOVEMBER 25, 2009
 CORRECTIONS AND ADDITIONS SHOULD BE BROUGHT TO THE ATTENTION OF THE ABOVE ORGANIZATION
 PHONE : (952) 891-7081
 This map was created using the FGDC Standard for the U.S. National Grid
 FGDC-STD-011-2001

For additional information
 see <http://www.fgdc.gov/usng>

| | | |
|------|------|------|
| 9832 | 9932 | 0032 |
| 9831 | 9931 | 0031 |
| 9830 | 9930 | 0030 |

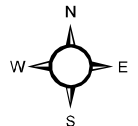

9931

Randolph/Hampton Fire District Street Index

Street Name: USNG Page #

#

220TH ST E: 9741, 9841
222ND ST E: 9841, 9941, 0041, 0141
225TH ST E: 0141, 0241
232ND ST E: 9739
240TH ST E: 9738, 9838, 9938
240TH ST E TO NB EMERY AVE: 0038
240TH ST E TO SB ROCHESTER BLVD: 0038
240TH ST E: 0038, 0138, 0238
245TH ST E: 9337, 9437, 9537, 9637
245TH ST W: 9237, 9337
250TH ST E: 9537, 9637, 9737, 9837, 9937, 0037, 0137, 0237
250TH ST W: 9237, 9337
260TH ST E: 9335, 9435, 9535, 9735, 9835, 9935, 0035
260TH ST W: 9035, 9135, 9235, 9335
265TH ST E: 9534, 9634, 9734
270TH ST E: 9333, 9433, 9533, 9633, 9733, 9833
270TH ST W: 8933, 9033, 9133, 9233, 9333
275TH ST W: 8933
277TH ST W: 9032, 9132
280TH ST E: 9332, 9432, 9532, 9632, 9732, 9832, 9932, 0032, 0132, 0232, 0332, 0432
280TH ST W: 8832, 8932, 9032, 9132, 9232, 9332
284TH ST E: 9831, 9931
287TH ST E: 0431
290TH ST E: 9330, 9430, 9530, 9630, 9730, 9830
290TH ST W: 8830, 9230, 9330
291ST ST E: 9830
292ND CT E: 0030
292ND ST E: 9630, 9730, 9830, 9930, 0030, 0129, 0130, 0430
294TH ST E: 0129, 0130
294TH ST: 0229, 0329
294TH STREET CT: 0130
295TH ST E: 0129, 0229, 0329, 0429
296TH ST E: 0129, 0229
300TH ST W: 9029, 9129, 9229
302ND ST E: 9328, 9628
302ND ST W: 9228, 9328
310TH ST E: 9327, 9427, 9527, 9627
310TH ST: 9627
313TH ST W: 9027
320TH ST E: 9325, 9425, 9525
320TH ST W: 9325
320TH ST E: 9625
320TH ST: 9625

A

AKRON AVE: 9332, 9333, 9334, 9335, 9337
ALEXANDER CT: 9325
ALTA AVE: 9325, 9326, 9327, 9328, 9329, 9330
ALVERNO AVE: 9235, 9236, 9237
ARKANSAS AVE: 9228, 9229, 9230, 9231, 9232
ASHBY CT: 9328, 9428, 9429
ASPEN ST: 9940
AUDREY AVE: 9437

B

BELLE CT: 0039
BELMONT ST: 0039, 0040
BIRCH BAY: 9939, 9940
BIRCH ST: 9939, 9940
BISCAYNE AVE: 9032, 9033, 9034, 9035
BLAINE AVE: 9532, 9533, 9534, 9535, 9536, 9537, 9538
BOYD AVE: 9527, 9625, 9626, 9627
BURMA AVE: 9029, 9030

C

CAMBODIA AVE: 8933
CANNON RIVER BLVD: 9127, 9227, 9327, 9328, 9428, 9528, 9529, 9629, 9729
CARDINAL CT: 0039
CHESLEY TRL: 9637, 9638, 9738
CHIPPENDALE AVE W: 8933
CHIPPENDALE AVE: 8830, 8930, 8931
CHIPPENDALE AVE W: 8932
CHIPPENDALE AVE: 8932
COATES BLVD: 0041
COLORADO AVE: 9939, 9940
CONRAD AVE: 9738, 9739
COOPER AVE: 9729, 9730
CORDELL CT: 9730
COUNTY ROAD 88: 9630
CURTIS LN: 9730
CYNTHIA PATH: 9730

D

DANBURY AVE: 8830, 8831, 8832
DANEL AVE: 9830
DARK HORSE LAKE LN: 9840, 9841
DARSOW AVE: 9841
DAVISSON AVE: 9830
DAWSON AVE: 9830
DICKMAN AVE: 9830, 9831, 9832
DINSMORE AVE: 9830
DISTAD PATH: 9830
DIVERS PATH: 9830
DIXIE AVE: 9829, 9830
DOFFING WAY: 9939, 0039
DONNELLY AVE: 9831, 9832, 9833, 9834, 9835, 9836, 9837
DOUGLAS AVE: 9830
DOWNING WAY: 9931
DOYLE TRL: 9830
DRESSLER CT: 9931
DUNCAN AVE: 9930
DUNCAN CT: 9930

E

EAGLE CT: 0039
ECHO POINT RD: 0328, 0428, 0429
EMERY AVE: 0032, 0033, 0034, 0035, 0036, 0037
EMERY AVE TO EB 240TH ST E: 0038
EMERY AVE TO SB ROCHESTER BLVD: 0038
EMERY AVE TO WB 240TH ST E: 0038
EMERY AVE: 0038
EMERY AVE TO WB 240TH ST E: 0039

Randolph/Hampton Fire District Street Index

Street Name: USNG Page #

EMERY AVE: 0039, 0040, 0041
ENDRESS CT: 0030
ENDRESS WAY: 0029, 0030
ENGER CT: 0030
EVA CT: 0040

F

FAITH CT: 0030, 0130
FELTON AVE: 0130, 0131, 0132
FINCH CT: 0229, 0230
FISCHER AVE: 0135, 0232, 0233, 0234, 0235, 0236
FRIENDLY AVE: 0229
FRONT ST: 9830
FULLERTON RD: 0229, 0230

G

GAYLORD AVE: 0329, 0330, 0331, 0332
GAYLORD CT: 0330, 0331
GERLACH WAY: 0329, 0428, 0429
GIBSON CIR: 0329
GRANT ST: 9939, 0039, 0329

H

HAGEN AVE: 0429
HAMILTON CT: 0430
HAMPTON AVE: 9840, 9841, 9939, 9940, 0039
HAMPTON BLVD: 9939, 9940, 0038, 0039
HARRY AVE: 0428, 0429, 0430, 0431, 0432
HAWKINS CT: 0429
HAZEL CIR: 0429
HEATHER LN: 0429
HIGHWAY 50: 9841
HIGHWAY 52: 0431, 0432
HIGHWAY 56 BLVD: 9829
HOGAN PATH: 0428

L

LEWISTON BLVD: 9835, 9935, 9936, 9937, 0037, 0038, 0138, 0139, 0140,
0240, 0241
LINCOLN ST: 0039

M

MAIN ST TO EB 240TH ST E: 0038
MAIN ST TO WB 240TH ST E: 0038
MAIN ST: 0038, 0039

N

NORTHFIELD BLVD: 9027, 9127, 9128, 9228, 9229, 9329, 9330, 9430, 9431,
9531, 9532, 9533, 9633, 9634, 9734, 9735, 9736, 9836, 9837, 9838, 9938,
9939, 0039, 0040, 0041, 0141

P

PARK ST: 0039
PRIVATE RD: 0431

R

RANDOLPH BLVD: 9829, 9929, 9930, 9931, 0031, 0032
ROCHESTER BLVD: 0037
ROCHESTER BLVD TO EB 240TH ST E: 0038
ROCHESTER BLVD: 0038, 0136, 0137, 0235, 0236, 0431, 0432

S

SCIOTA TRL: 9227, 9327, 9427, 9428, 9528, 9628
SIBLEY ST: 9830
SUN VALLEY LN: 9939

U

UPPER 291ST ST E: 9830

W

WATER ST: 9939, 0039